

# Measuring Guidelines

Absolute accuracy is essential when measuring for any Kensington window treatment. Always use a metal tape ruler. As a dealer, you are responsible for correct measuring. Your fabricator is not accountable for incorrect measurements.

## **Measuring for Inside Mounts (Fig. 1)**

- Measure the width (A) inside the window opening at the top, middle and bottom.
- Measure the height (B) inside the window opening at the left, right and center.
- Order the narrowest width measurement and the shortest height measurement.
- Measure window on the diagonal (C). If the two diagonal dimensions are not exactly the same, it may be more appropriate to specify an outside mount shade for optimal light control and privacy. *For inside mounts, allowance for window clearance will be made automatically at the factory.*

## **Measuring for Outside Mounts (Fig. 1)**

- First, measure exact width and height of area to be covered. For best appearance, we recommend adding 6" to opening width measurement (A) and 2" to opening height measurement (B) where possible.

*Verticals will be fabricated for outside mounting to the exact measurements ordered. Be precise!*

## **Measuring for Specialty Systems**

Select the diagram that matches your window type and take all measurements accordingly. A template for the blind using these measurements **must** be provided. (See page 25 for template preparation.) Check the accuracy of the template by "installing" it in the window opening. Be sure to indicate all measurements on the template, plus "room side", "top" as well as customer name and P.O. #.

## **Arched Windows**

When measuring an arched window (Fig. 2), (A) is the width, (B) is the radius (or "height") of the curved portion, and (D) is the circumference.

All measurements are necessary, since the arch may not be a perfect circle. For Palladian windows, the height (C) from the base of the arch to the bottom of the window must also be measured.

**Bay or Curved Windows**

When measuring a bay or curved window (Fig. 3), (A) is the width across the front of the curved portion, (C) is the height of the window, (D) is the circumference and (B) is the radius (or "depth") of the bay. Note also how far from the window the blind should be. Standard choice is 2" to the center of the track; additional clearance may also be needed for window seals or crank handles. Measure straight sections as you would for any vertical blind.

**Angled Windows**

When measuring angled windows, (A) is the width, (B) is the height and (C) is the length of the angled side or sides. The degree of the angle (X) is measured from the horizontal. Measure straight sections as you would for any vertical blind.

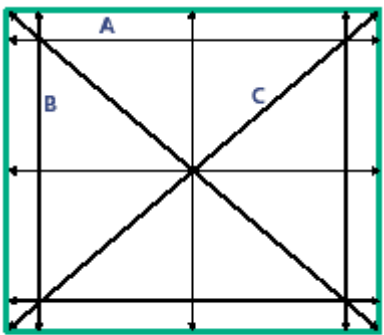

Fig. 1

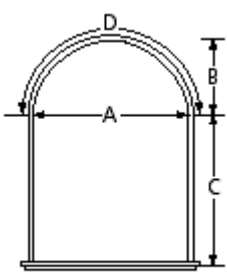

Fig. 2

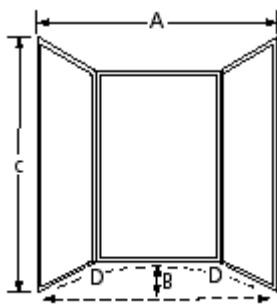
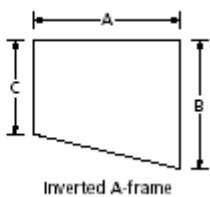
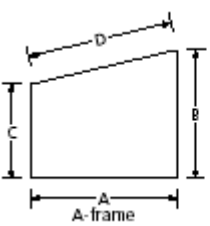
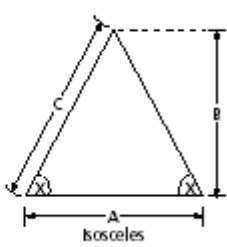
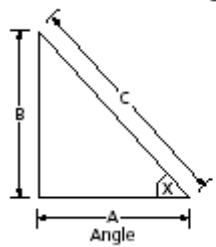
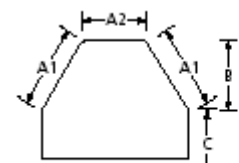

Fig. 3

Fig. 4





Sloped/straight combination

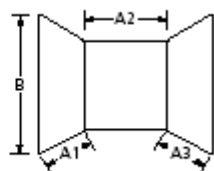

Bay

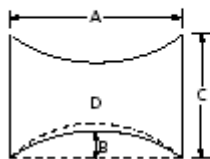

Curved bay

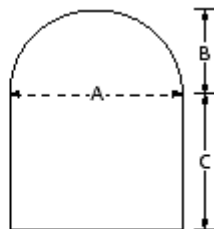

Palladian

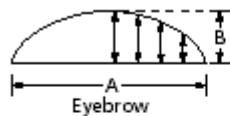

Eyebrow

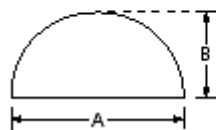

Arch

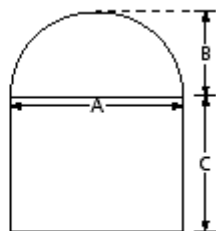

Palladian arch and rectangle

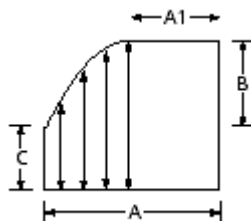

Arch/straight combination